

10445861 - LED-DECKENLEUCHTE

Demontage und Entsorgung

! **Warnung:** Die folgenden Arbeitsschritte dürfen nur von Elektrofachkräften durchgeführt werden.

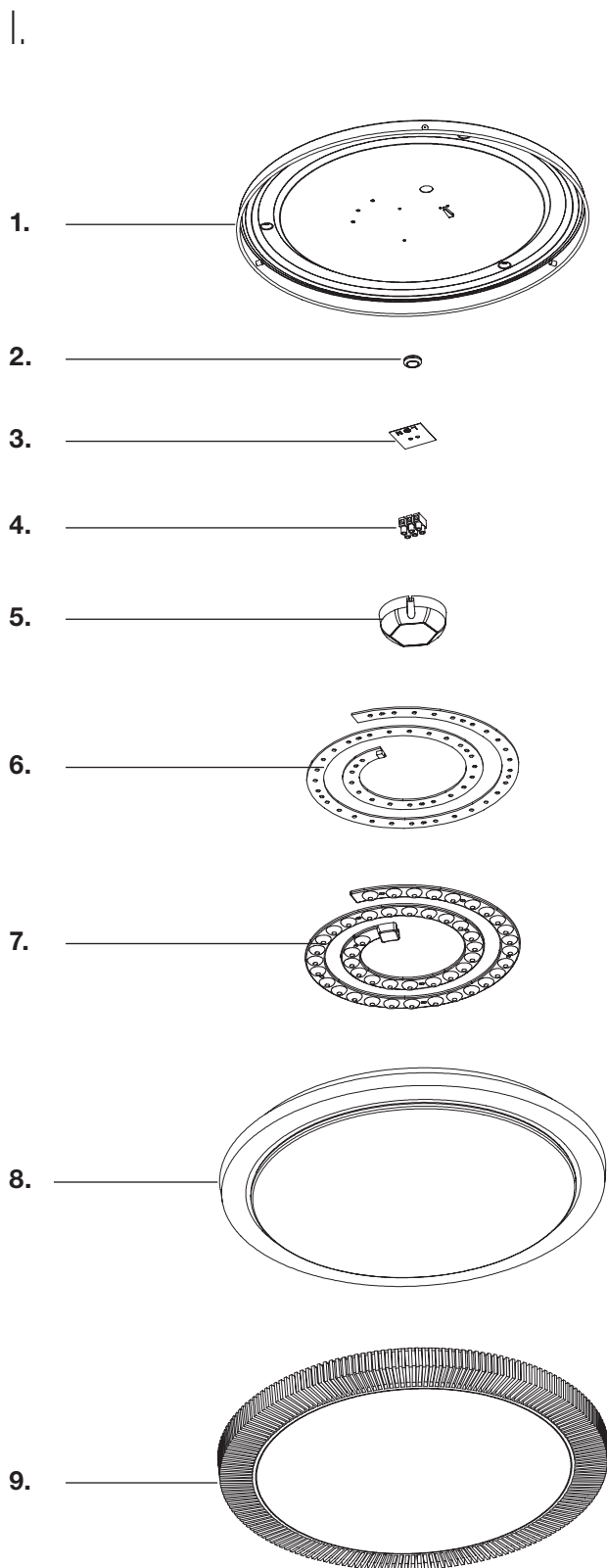

II.

! **Vorsicht:** Vor jeglichen Arbeiten am Gerät die Leuchte vom Netz trennen.

Demontage

1. Die Grundplatte **1** von der Opalabdeckung **8** abschrauben.
2. Den Dichtungsring **2** entfernen.
3. Die Schrauben der Lüsterklemme **4** lösen und diese zusammen mit dem Isolations-Abstandhalter **3** entfernen.
4. Die Schrauben des LED-Treibers **5** lösen.
5. Die Plastikstifte der Halterung der LED-Platine **6** und der Abdecklinsen **7** abwickeln und beide entfernen.
6. Die Dekorwanne **9** von der Opalabdeckung **8** abziehen.

III.



Die einzelnen Bauteile entsprechend geltenden Vorschriften entsorgen!

Bauteil

1	Grundplatte
2	Dichtungsring
3	Isolations- Abstandhalter
4	Lüsterklemme
5	LED-Treiber
6	LED-Platine
7	Linsen
8	Opalabdeckung
9	Dekor-Einfassung

IV.

Benötigtes Werkzeug

-  Kreuzschlitzschraubendreher
-  Schraubendreher
-  Zange

HORNBACH Baumarkt AG
Hornbachstraße 11
76879 Bornheim / Deutschland

www.hornbach.com

PLAFONNIER LED 10445861

Démontage et élimination



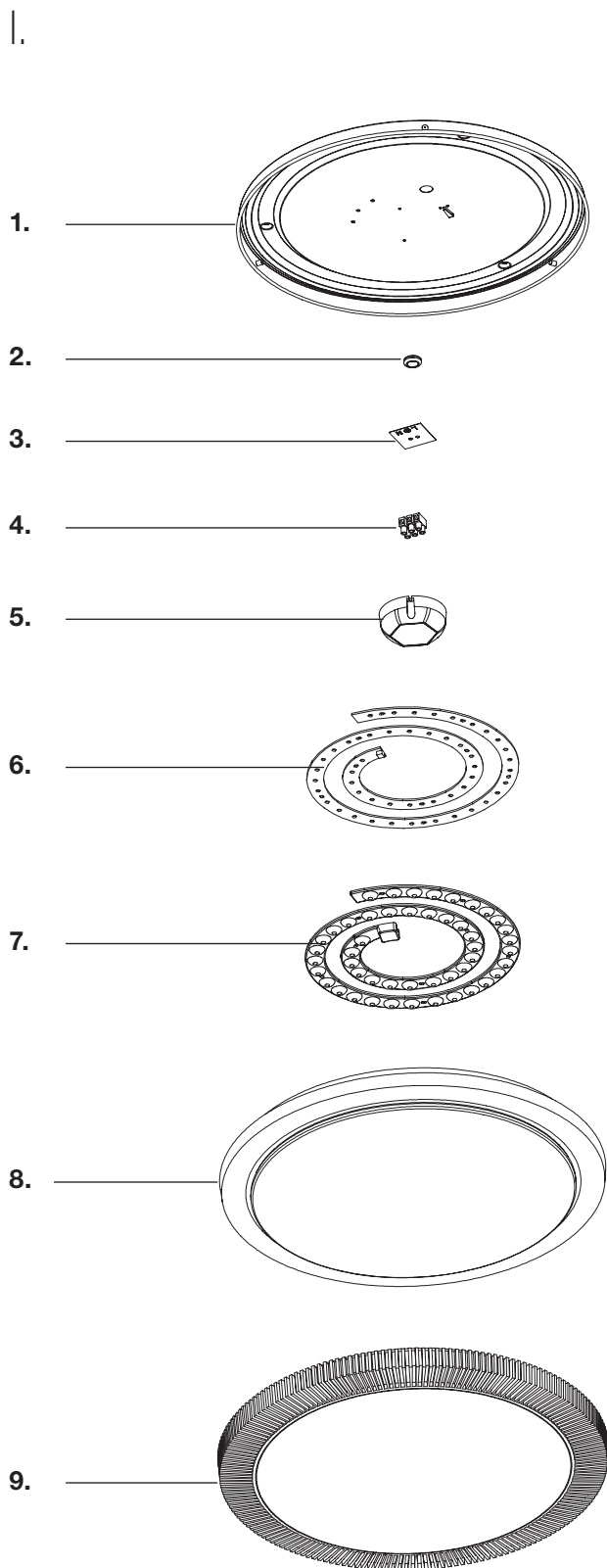

 **Avertissement : Le travail suivant doit être effectué par un électricien qualifié.**



II.

 **Attention: débrancher l'appareil de l'alimentation électrique avant toute opération.**

Démontage

1. Dévisser la base **1** de l'abat-jour Milky **8**.
2. Retirer la bague de protection **2** .
3. Desserrer les vis du connecteur à 3 broches **4**  et le retirer avec l'entretoise isolante **3**.
4. Retirer les vis de la plaque LED SMT **3** .
5. Pincer les broches en plastique qui maintiennent la plaque LED SMT **6** et la lentille en forme de serpent **7**  et les retirer.
6. Retirer le cadre de luminaire **9** de l'abat-jour Milky **8**.

III.



Jeter les différents composants conformément aux réglementations en vigueur !

Composant

1	Base (30 lentilles)
2	Bague de protection
3	Entretoise isolante
4	Connecteur à 3 broches
5	Circuit de commande à tension constante
6	Plaque LED SMT
7	Lentille en forme de serpent
8	Abat-jour Milky
9	Cadre de luminaire

IV.

Outils nécessaires

-  Tournevis à pointe cruciforme
-  Tournevis
-  Pince

HORNBAACH Baumarkt AG
Hornbachstraße 11
76879 Bornheim / Deutschland

www.hornbach.com

LAMPADA DA SOFFITTO A LED - 10445861

Smontaggio e smaltimento



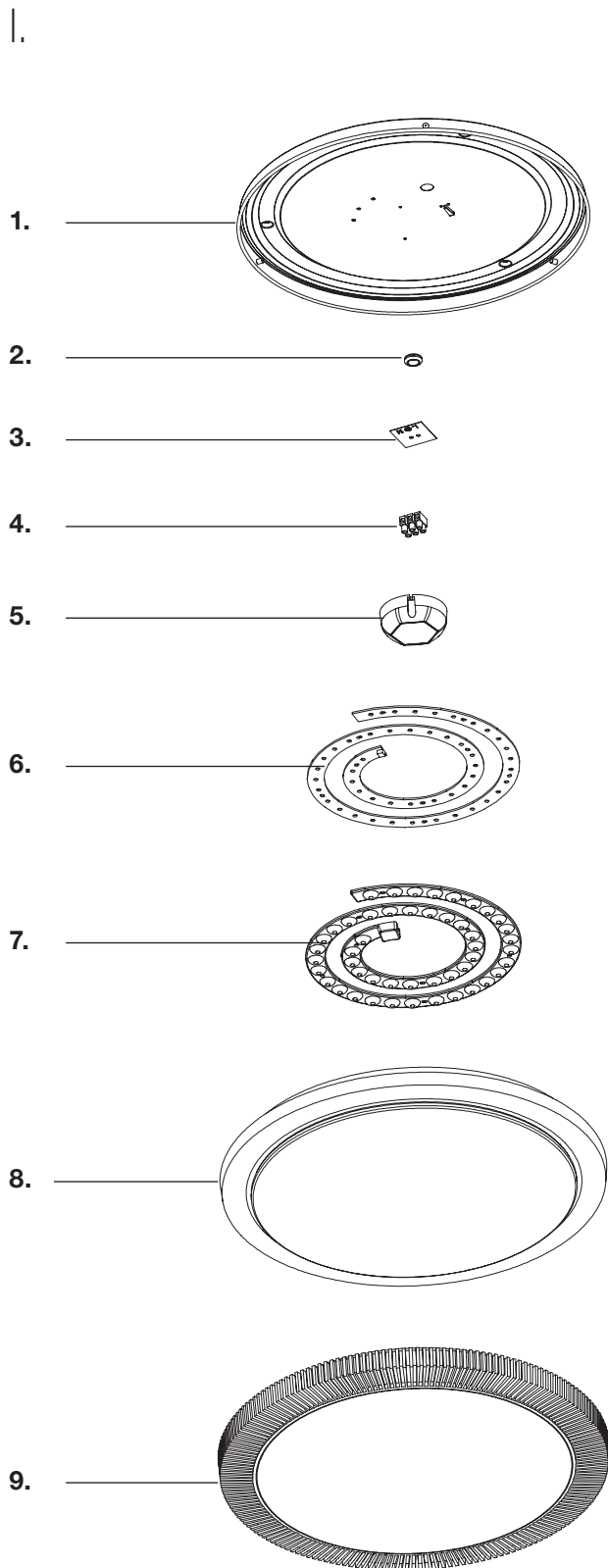

 **Avvertenza: I seguenti lavori devono essere eseguiti da un elettricista qualificato.**



II.

 **Attenzione: Scollegare il dispositivo dalla rete elettrica prima di effettuare qualsiasi intervento.**

Smontaggio

1. Svitare la base **1** dal paralume Milky **8**.
2. Rimuovere la ghiera protettiva **2** .
3. Allentare le viti del connettore a 3 pin **4**  e rimuoverlo insieme al distanziatore isolante **3**.
4. Rimuovere le viti dalla scheda LED SMT **6** .
5. Sganciare i perni di plastica che trattengono la scheda LED SMT **6** e le lenti a chiocciola **7**  e rimuovere entrambi.
6. Rimuovere la montatura della lampada **9** dal paralume milky **8**.

III.



Smaltire i componenti specifici secondo le normative vigenti!

Componente

1	Base (lenti 30 pezzi)
2	Ghiera protettiva
3	Distanziatore isolante
4	Connettore a 3 pin
5	Driver a tensione costante
6	Scheda LED SMT
7	Lenti a chiocciola
8	Paralume milky
9	Montatura della lampada

IV.

Utensili richiesti

-  Cacciavite con punta a croce
-  Cacciavite
-  Pinze

HORNBACH Baumarkt AG
Hornbachstraße 11
76879 Bornheim / Germania

www.hornbach.com

10445861 - LED-PLAFONDARMATUUR

Demontage en verwijdering

 **Waarschuwing:** De volgende werkzaamheden moeten worden uitgevoerd door een gekwalificeerde elektricien.

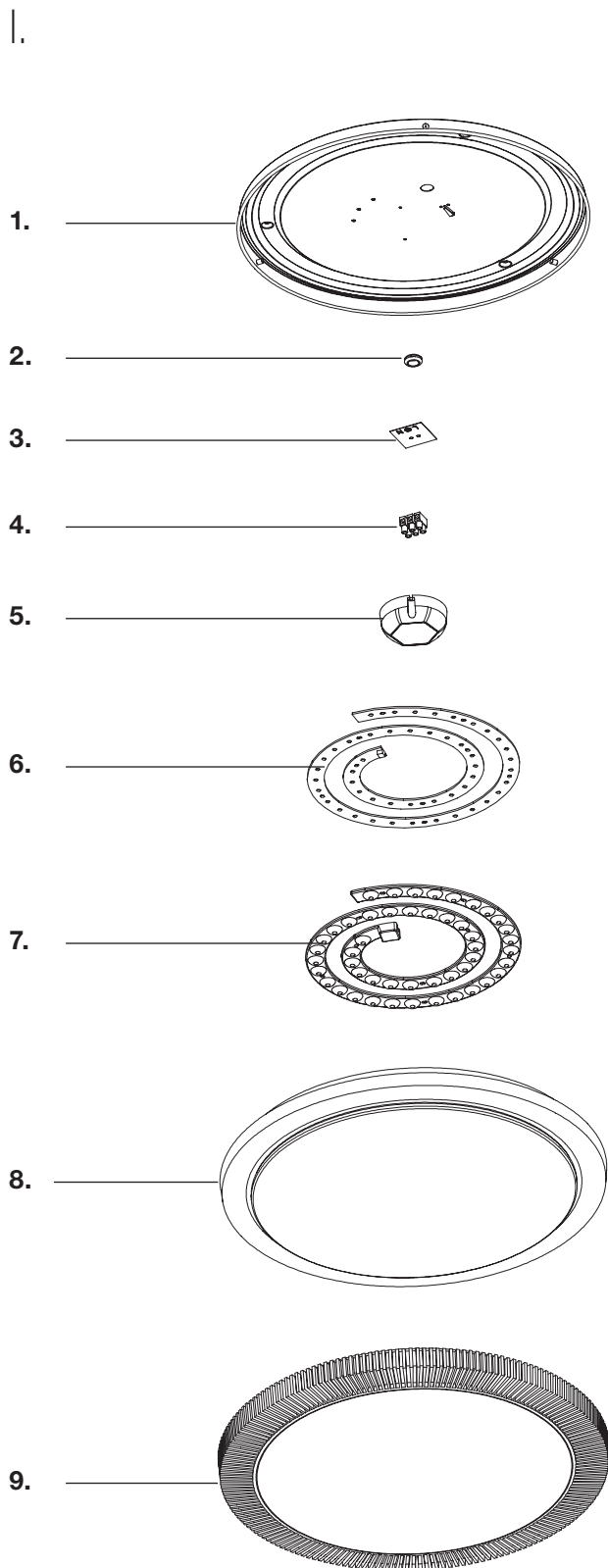

II.

 **Voorzichtig:** Ontkoppel het apparaat van het lichtnet voordat u enige handelingen aan het apparaat verricht.

Demontage

1. Schroef de basisplaat **1** los van de melkachtige lampenkap **8**.
2. Verwijder de beschermring **2** .
3. Draai de schroeven van de 3-pins connector **4**  los en verwijder deze samen met de isolerende afstandsbuis **3**.
4. Verwijder de schroeven van de SMT LED-printplaat **6** .
5. Knip de plastic pinnen af waarmee de SMT LED-printplaat **6** en de spiraalvormige lens **7**  vastzitten en verwijder beide.
6. Verwijder de decoratieve rand **9** van de melkachtige lampenkap **8**.

III.



Voer de afzonderlijke componenten af volgens de geldende voorschriften!

Component

1	Basisplaat (30st lens)
2	Beschermring
3	Isolerende afstandshouder
4	3-pins connector
5	Constante spanningsdriver
6	SMT LED-printplaat
7	Slangvormige lens
8	Melkachtige lampenkap
9	Decoratieve rand

IV.

Benodigd gereedschap

	Kruiskopschroevendraaier
	Schroevendraaier
	Tang

HORNBACH Baumarkt AG
Hornbachstraße 11
76879 Bornheim/Duitsland

www.hornbach.com

10445861 - LED-ARMATUR

Demontering och avfallshantering

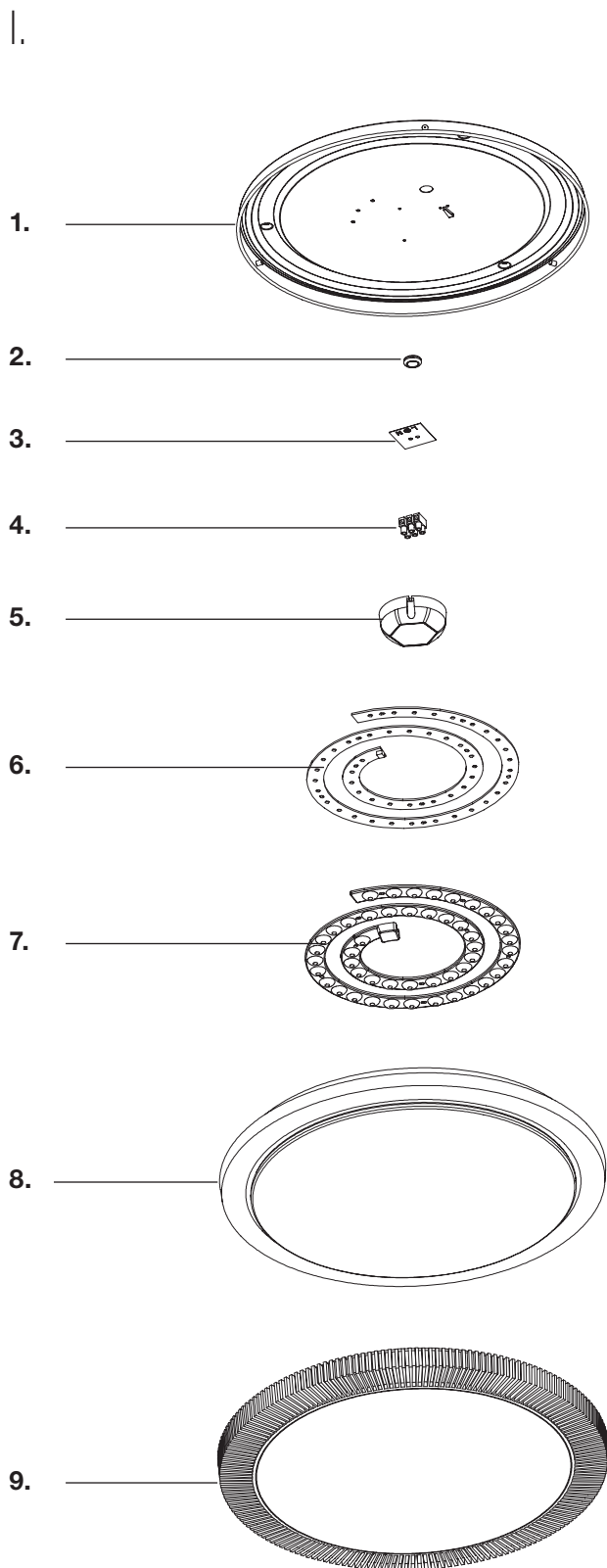

 **Varning: Följande arbete ska utföras av behörig elektriker.**



II.

 **Observera: Koppla bort nätströmmen innan du utför något arbete på enheten.**

Demontering

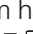
1. Skruva loss basen **1** från Milky lampskärmen **8**.
2. Ta bort skyddsringen **2** .
3. Lossa skruvarna på 3-poliga kontakten **4**  och ta bort den tillsammans med den isolerande distansen **3**.
4. Ta bort skruvarna från SMT LED-kortet **3** .
5. Kläm av plaststiften som håller SMT LED-kortet **6** och den ormformade linsen **7**  och ta bort båda.
6. Ta bort lampramen **9** från milky lampskärmen **8**.

III.

Kassera de enskilda komponenterna enligt gällande bestämmelser!

Komponent

1	Bas (30st linser)
2	Skyddsring
3	Isolerande distans
4	3-polig kontakt
5	Drivspänning för konstant spänning
6	SMT LED-kort
7	Ormformad lins
8	Milky lampskärm
9	Lampram

IV.

Nödvändiga verktyg

	Stjärnskruvmejsel
	Skruvmejsel
	Tång

HORNBAACH Baumarkt AG
Hornbachstraße 11
76879 Bornheim / Tyskland

www.hornbach.com

10445861 - STROPNÍ LED SVÍTIDLO

Demontáž a likvidace



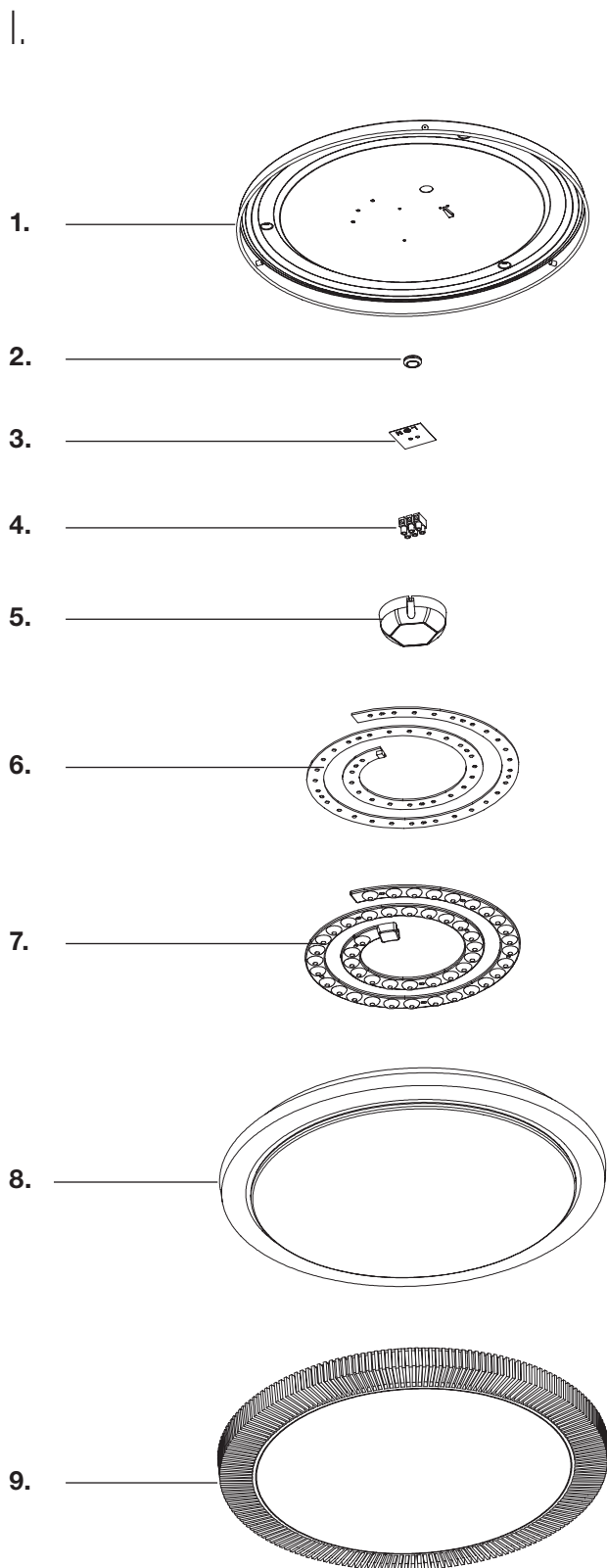

 **Výstraha:** Následující práce musí být vykonána kvalifikovaným elektrikářem.



II.

 **Upozornění:** Před jakýmkoli úkony na zařízení jej odpojte od sítě.

Demontáž

1. Odšroubujte základnu **1** od stínidla z mléčného skla **8**.
2. Odstraňte ochranný kroužek **2** .
3. Uvolněte šrouby 3kolíkového konektoru **4**  a odstraňte jej spolu s izolační podložkou **3**.
4. Odstraňte šrouby z desky SMT LED **3** .
5. Skřípnutím plastových kolíků, které drží SMT LED desku **6** a hadovitou čočku **7**  a obojí odstraňte.
6. Sejměte rám svítidla **9** ze stínidla z mléčného skla **8**.

III.

Zlikvidujte jednotlivé komponenty dle platných předpisů!

Komponenta

1	Základna (30 ks čoček)
2	Ochranný kroužek
3	Izolační podložka
4	3pinový konektor
5	Regulátor konstantního napětí
6	SMT LED deska
7	Hadovitá čočka
8	Stínidlo z mléčného skla
9	Rám svítidla

IV.

Potřebné nástroje

-  Křížový šroubovák
-  Šroubovák
-  Kleště

HORNBACH Baumarkt AG
Hornbachstraße 11
76879 Bornheim / Německo

www.hornbach.com

10445861 – LED STROPNÉ SVIETIDLO

Demontáž a likvidácia



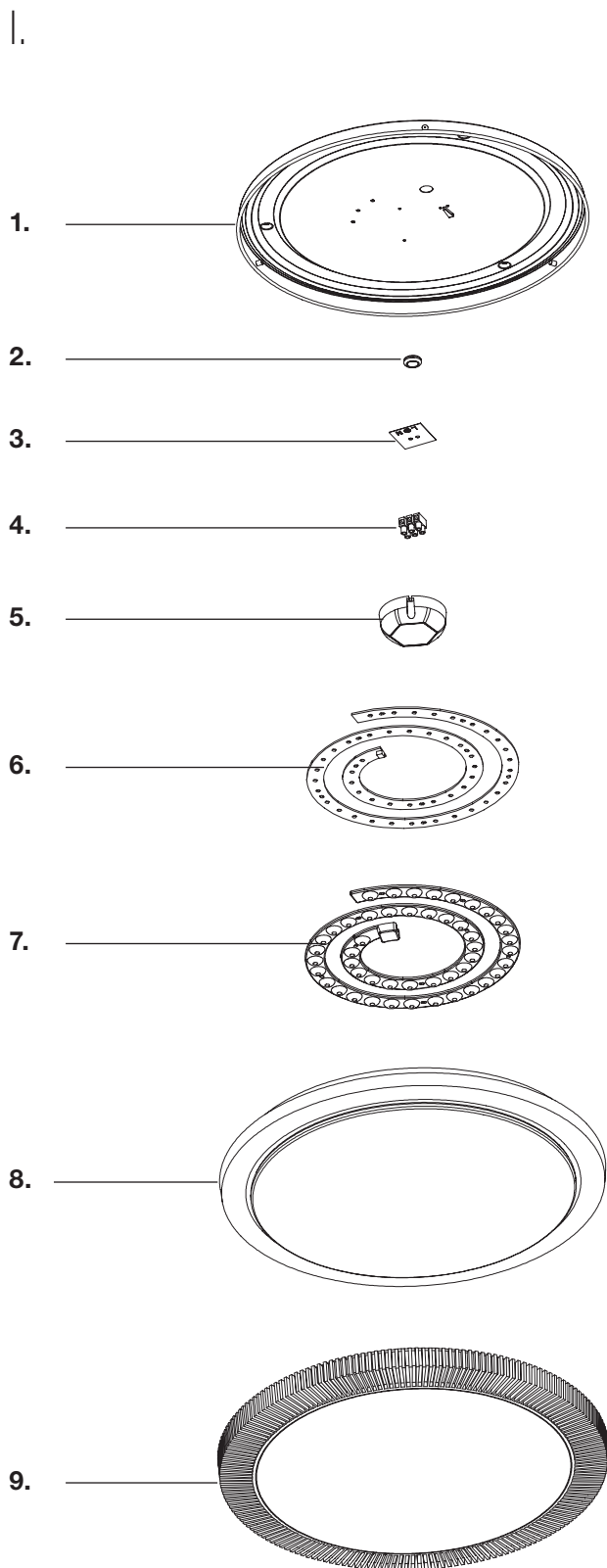

 **Výstraha: Nasledovné práce musí vykonávať kvalifikovaný elektrikár.**



II.

 **Upozornenie: Pred vykonávaním akejkoľvek práce na zariadení odpojte sieťové napájanie.**

Demontáž

1. Odskrutkujte základňu **1** z mliečneho tienidla lampy **8**.
2. Odstráňte ochranný krúžok **2** .
3. Uvoľnite skrutky 3-kolíkového konektora **4**  a odstráňte ho spolu s izolačnou vložkou **3**.
4. Odstráňte skrutky z SMT LED dosky **3** .
5. Vytiahnite plastové kolíky, ktoré pridržajú dosku SMT LED **6** a šošovky v tvare hadieho oka **7** , a odstráňte ich.
6. Odstráňte rám lampy **9** z mliečneho tienidla lampy **8**.

III.



Jednotlivé komponenty zlikvidujte v súlade s platnými predpismi!

Komponent

- | | |
|----------|-----------------------------|
| 1 | Základňa (30 ks šošoviek) |
| 2 | Ochranný krúžok |
| 3 | Izolačná vložka |
| 4 | 3-kolíkový konektor |
| 5 | Budič s konštantným napätím |
| 6 | SMT LED doska |
| 7 | Šošovky v tvare hadieho oka |
| 8 | Mliečne tienidlo lampy |
| 9 | Rám lampy |

IV.

Potrebné nástroje

- | | |
|-------------------------------------------------------------------------------------|--------------------|
|  | Křížový škrutkovač |
|  | Škrutkovač |
|  | Kliešte |

HORNBACH Baumarkt AG
Hornbachstraße 11
76879 Bornheim/Nemecko

www.hornbach.com

10445861 - PLAFONIERĂ CU LED

Demontarea și eliminarea



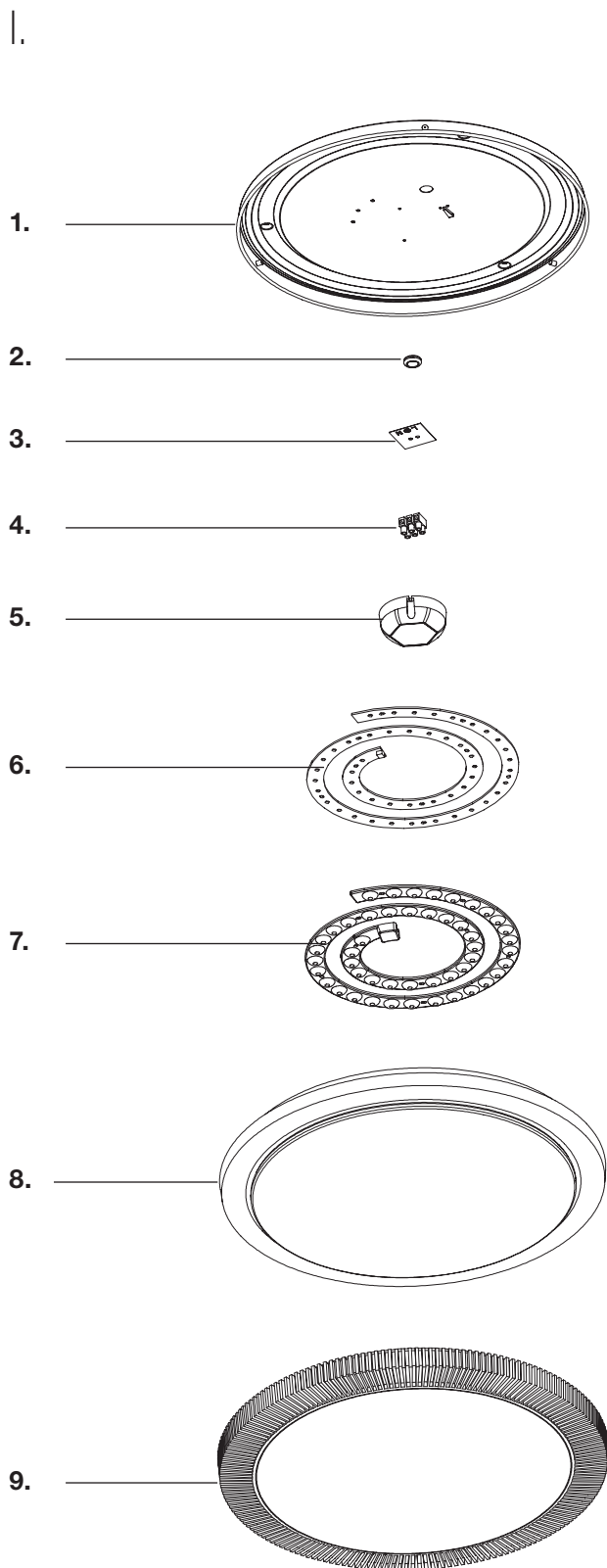

 **Avertisment:** Lucrarea următoare trebuie efectuată de un electrician calificat.



II.

 **Atentie:** Înainte de a efectua orice operațiuni pe dispozitiv, deconectați-l de la rețeaua de alimentare cu energie electrică.

Demontarea

1. Deșurubați baza **1** de pe abajurul alb ca laptele **8**.
2. Îndepărtați inelul de protecție **2** .
3. Slăbiți șuruburile conectorului cu 3 pini **4**  și îndepărtați-l împreună cu distanțierul de izolare **3**.
4. Îndepărtați șuruburile de pe banda LED SMT **3** .
5. Scoateți pini din plastic care susțin banda LED SMT **6** și lentila în formă de șarpe **7**  și îndepărtați-le.
6. Îndepărtați cadrul lămpii **9** de pe abajurul alb ca laptele **8**.

III.



Eliminați componentele individuale în conformitate cu reglementările în vigoare!

Componentă

- | | |
|----------|---------------------------------|
| 1 | Bază (30 buc. lentile) |
| 2 | Inel de protecție |
| 3 | Distanțier de izolare |
| 4 | Conector cu 3 pini |
| 5 | Conductor de tensiune constantă |
| 6 | Bandă LED SMT |
| 7 | Lentilă în formă de șarpe |
| 8 | Abajur alb ca laptele |
| 9 | Cadru lampă |

IV.

Instrumente necesare

- | | |
|-------------------------------------------------------------------------------------|----------------------|
|  | Șurubelniță în cruce |
|  | Șurubelniță |
|  | Clești |

HORNBACH Baumarkt AG
Hornbachstraße 11
76879 Bornheim / Deutschland

www.hornbach.com

10445861 - LED-CEILING LUMINAIRE

Dismounting and disposal



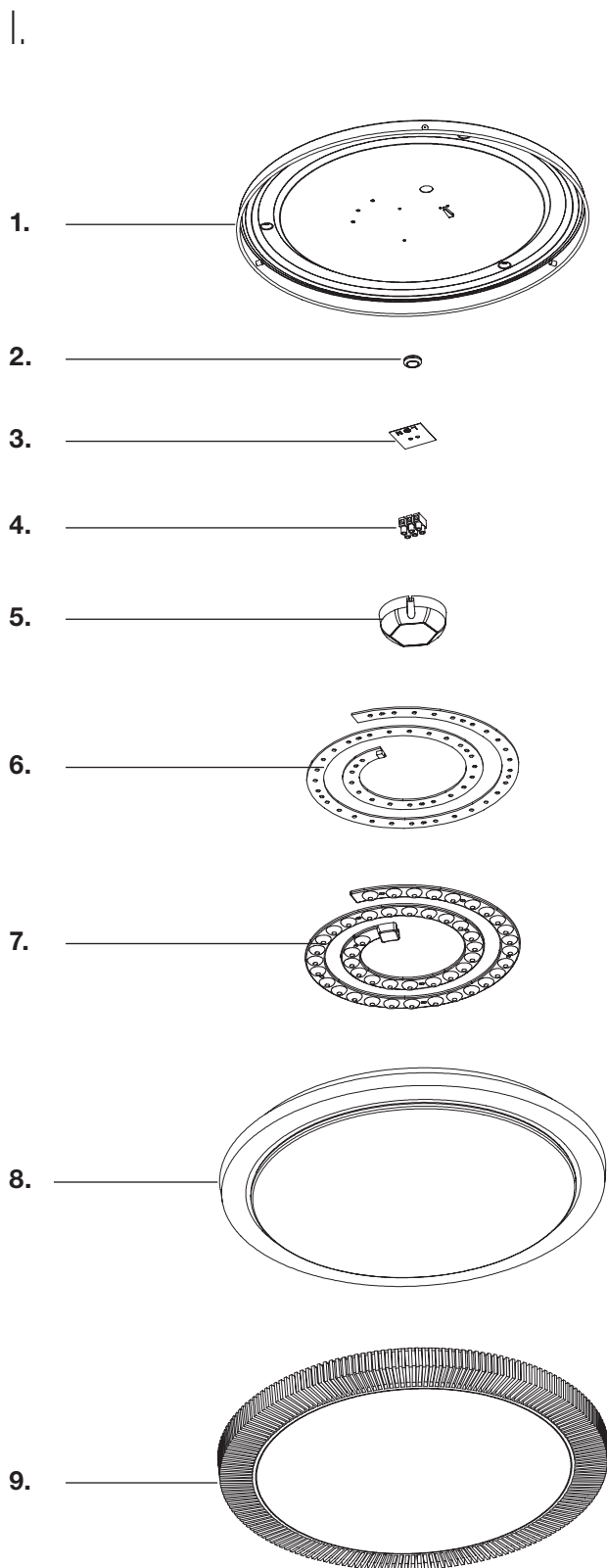

⚠ Warning: The following work must be performed by a qualified electrician.



II.

⚠ Caution: Disconnect from power mains prior to any operations on the device.

Dismounting

1. Unscrew the base **1** from the Milky lamp shade **8**.
2. Remove the protective ring **2** .
3. Loosen the screws of the 3 Pin connector **4**  and remove it together with the insulating spacer **3**.
4. Remove the screws from the SMT LED board **3** .
5. Pinch off the plastic pins that hold the SMT LED board **6** and the snake shape lens **7**  and remove both.
6. Remove the lamp frame **9** from the milky lamp shade **8**.

III.



Dispose of the individual components according to the applicable regulations!

Component

1	Base (30pcs lens)
2	Protective ring
3	Insulating spacer
4	3 Pin connector
5	Constant voltage driver
6	SMT LED board
7	Snake shape lens
8	Milky lamp shade
9	Lamp frame

IV.

Required tools

	Cross-tip screwdriver
	Screwdriver
	Pliers

HORNBACH Baumarkt AG
Hornbachstraße 11
76879 Bornheim / Deutschland

www.hornbach.com