

10446980 - LED-WANDLEUCHE

Demontage und Entsorgung

! **Warnung:** Die folgenden Arbeitsschritte dürfen nur von Elektrofachkräften durchgeführt werden.

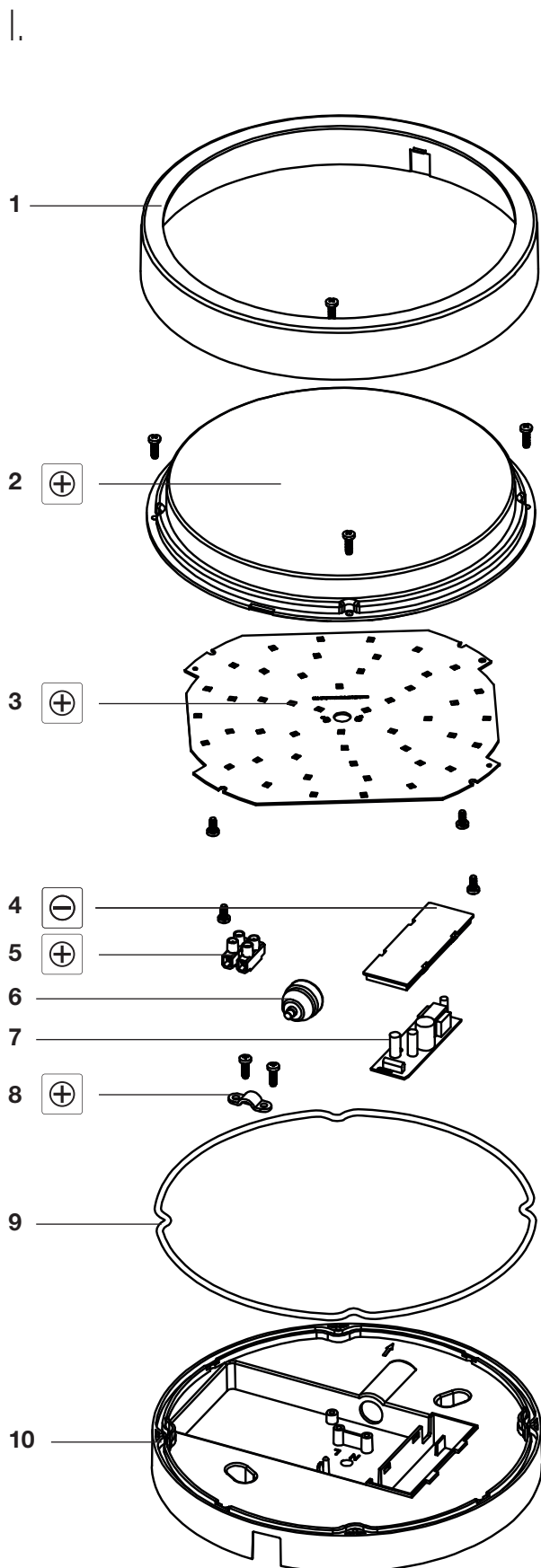

II.

! **Vorsicht:** Vor jeglichen Arbeiten am Gerät die Leuchte vom Netz trennen.

Demontage

1. Die Dekor-Einfassung **1** von der Leuchte abziehen.
2. Die Opalabdeckung **2** abschrauben.
3. Die Schrauben der Lüsterklemme **5** lösen.
4. Die Steckverbindung im Kabel zwischen LED-Platine **3** und LED-Treiber **7** lösen.
5. Die Schrauben der Zugentlastung **8** lösen.
6. Die LED-Platine **3** von der Opalabdeckung abschrauben.
7. Die Abdeckung **4** des LED-Treibers abhebeln.
8. Den LED-Treiber **7** entnehmen.

III.

Die einzelnen Bauteile entsprechend geltenden Vorschriften entsorgen!

Bauteil

- | | |
|----|-----------------------|
| 1 | Dekor-Einfassung |
| 2 | Opalabdeckung |
| 3 | LED-Platine |
| 4 | Abdeckung LED-Treiber |
| 5 | Lüsterklemme |
| 6 | Dichtung |
| 7 | LED-Treiber |
| 8 | Zugentlastung |
| 9 | Dichtungsring |
| 10 | Grundplatte |

IV.

Benötigtes Werkzeug

- | | |
|--|-----------------------------|
| | Kreuzschlitzschraubendreher |
| | Schraubendreher |

HORNBACH Baumarkt AG
Hornbachstraße 11
76879 Bornheim / Deutschland

www.hornbach.com

10446980 - APPLIQUE LUMINAIRE LED

Démontage et mise au rebut

⚠ Avertissement : Les opérations suivantes doivent être effectuées par un électricien qualifié.

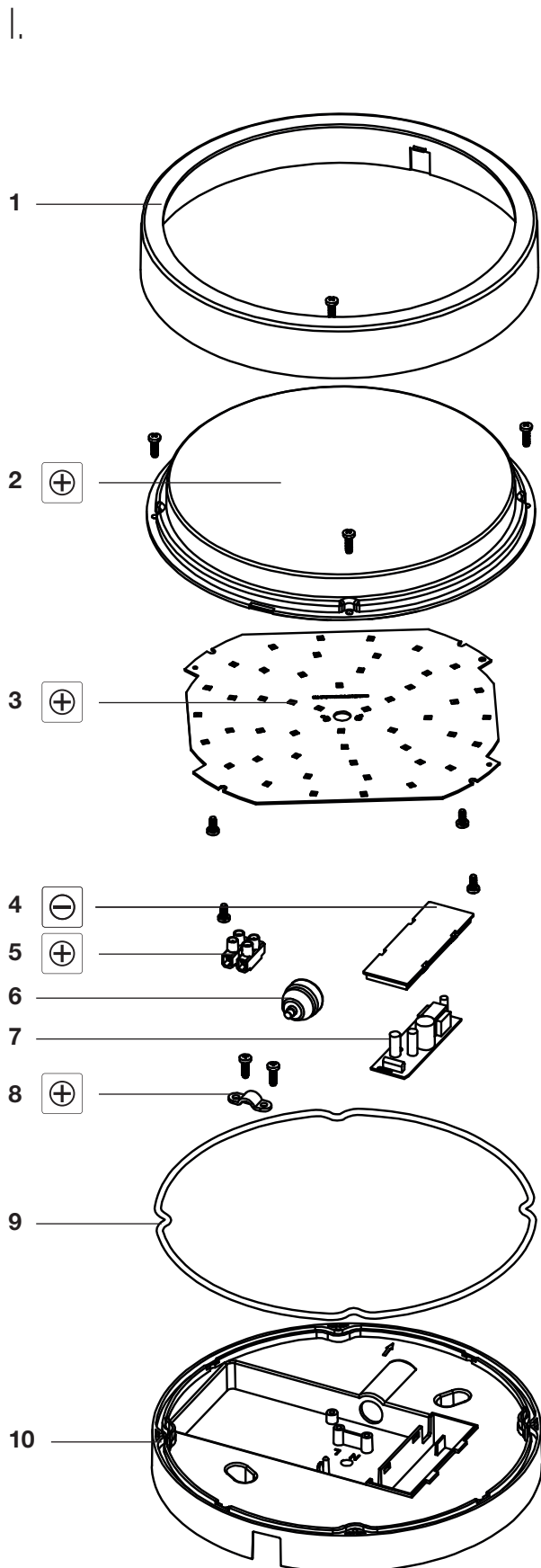

II.

⚠ Attention : Débrancher de l'alimentation secteur avant toute opération sur l'appareil.

Démontage

1. Retirer le boîtier de lampe **1** du luminaire.
2. Dévisser l'abat-jour **2** ⊕.
3. Desserrer les vis du bornier **5** ⊕.
4. Débrancher la connexion entre la plaque de LED **3** et la commande de LED **7**.
5. Desserrer les vis du réducteur de tension **8** ⊕.
6. Dévisser la plaque de LED **3** ⊕ de l'abat-jour.
7. Enlever le couvercle **4** ⊖ de la commande de LED.
8. Retirer la commande de LED **7**.

III.

Mettre les différents composants au rebut selon les réglementations applicables !

Composant

1	Boîtier de lampe
2	Abat-jour blanc
3	Plaque de LED
4	Couvercle de la commande de LED
5	Bornier
6	Joint
7	Commande de LED
8	Réducteur de tension
9	Bague d'étanchéité
10	Châssis

IV.

Outils requis

⊕	Tournevis cruciforme
⊖	Tournevis

HORNBACH Baumarkt AG
Hornbachstraße 11
76879 Bornheim / Deutschland

www.hornbach.com

10446980 - PLAFONIERA LED

Smontaggio e smaltimento



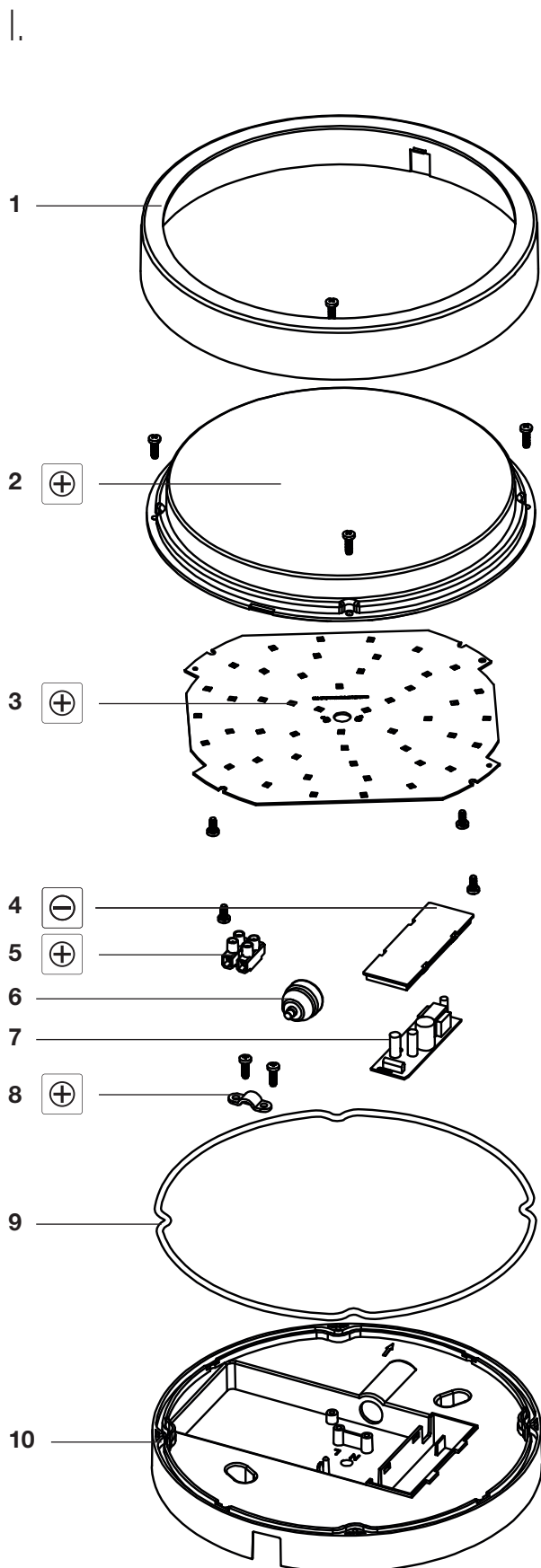

 **Avvertenza: i seguenti lavori devono essere eseguiti da un elettricista qualificato.**



II.

 **Attenzione: scollegare dalla rete elettrica prima di qualsiasi operazione sul dispositivo.**

Smontaggio

1. Rimuovere il telaio della lampada **1** dall'apparecchio.
2. Svitare il paralume **2** .
3. Allentare le viti della morsettiera **5** .
4. Rimuovere il collegamento tra la scheda LED **3** e il driver LED **7**.
5. Allentare le viti del pressacavo **8** .
6. Svitare la scheda LED **3**  dal paralume.
7. Sollevare il coperchio **4**  del driver LED.
8. Rimuovere il driver LED **7**.

III.



Smaltire i singoli componenti secondo le normative vigenti!

Componente

- | | |
|----|--------------------------|
| 1 | Telaio lampada |
| 2 | Paralume lattiginoso |
| 3 | Scheda LED |
| 4 | Copertura del driver LED |
| 5 | Morsettiera |
| 6 | Grado di protezione |
| 7 | Driver LED |
| 8 | Serracavo |
| 9 | Anello di tenuta |
| 10 | Alloggiamento |

IV.

Utensili richiesti

- | | |
|---|--------------------|
|  | Cacciavite a croce |
|  | Cacciavite |

HORNBACH Baumarkt AG
Hornbachstrasse 11
76879 Bornheim / Germania

www.hornbach.com

10446980 - LED-SCHOTARMATUUR

Demontage en afvoeren

! **Waarschuwing:** De volgende werkzaamheden moeten worden uitgevoerd door een gekwalificeerde elektricien.

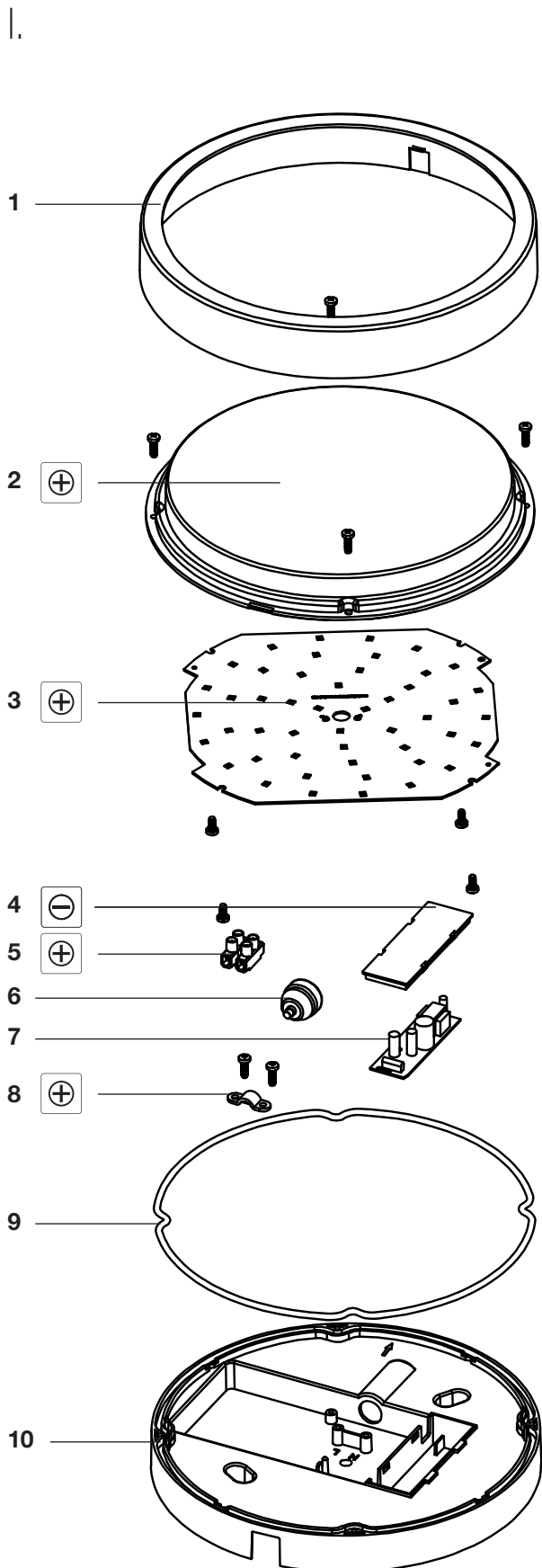

II.

! **Voorzichtig:** Haal de stekker uit het stopcontact voordat u werkzaamheden aan het apparaat uitvoert.

Demontage

1. Verwijder het lampframe **1** uit de armatuur.
2. Schroef de lampenkap **2** los.
3. Draai de schroeven van het klemmenblok **5** los.
4. Koppel de verbinding tussen de LED-kaart **3** en de LED-driver **7** los.
5. Draai de schroeven van de trekontlasting **8** los.
6. Schroef de LED-kaart **3** los van de lampenkap.
7. Licht de afdekking **4** van de LED-driver eraf.
8. Verwijder de LED-driver **7**.

III.

Voer de afzonderlijke onderdelen volgens de geldende voorschriften af!

Component

1	Lampframe
2	Melkachtige lampenkap
3	LED-kaart
4	Afdekking van LED-driver
5	Klemmenblok
6	Afdichting
7	LED-driver
8	Trekontlasting
9	Afdichtingsring
10	Behuizing

IV.

Vereist gereedschap

	Kruiskopschroevendraaier
	Schroevendraaier

HORNBACH Baumarkt AG
Hornbachstraße 11
76879 Bornheim / Deutschland

www.hornbach.com

10446980 - LED-BELYSNINGSARMATUR

Demontering och bortskaffande



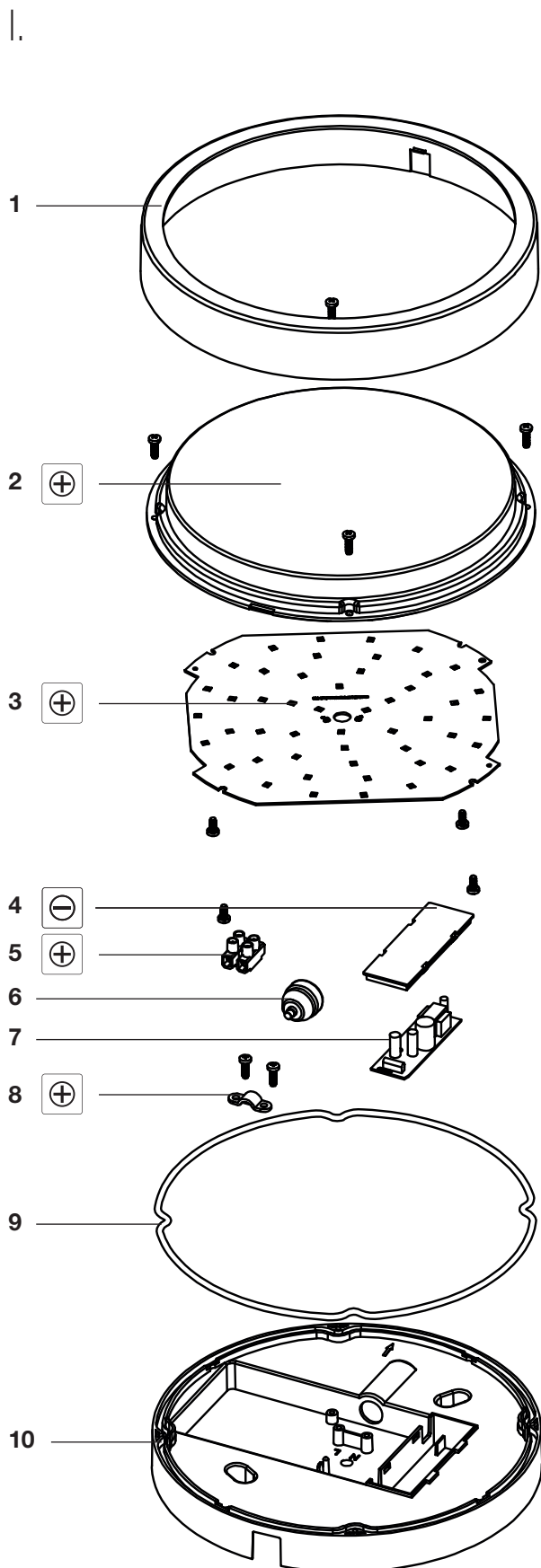

 **Varning: Följande arbete ska endast utföras av behörig elektriker.**



II.

 **Observera: Koppla från elnätet innan du utför något arbete på enheten.**

Demontering

1. Ta bort lampramen **1** från armaturen.
2. Skruva loss lampskärmen **2** .
3. Lossa på anslutningsplintens skruvar **5** .
4. Koppla ur anslutningen mellan LED-ljusbrädan **3** och LED-drivern **7**.
5. Lossa skruvarna på dragavlastningen **8** .
6. Skruva loss LED-ljusbrädan **3**  från lampskärmen
7. Lyft av locket **4**  på LED-drivern.
8. Ta bort LED-drivern **7**.

III.



Kassera de enskilda komponenterna enligt gällande bestämmelser!

Komponent

1	Lampram
2	Lampskärm i opalglas
3	LED-ljusbräda
4	Lock till LED-driver
5	Anslutningsplint
6	Tätning
7	LED-driver
8	Dragavlastning
9	Tätningsring
10	Hölje

IV.

Nödvändiga verktyg

	Stjärnskruvmejsel
	Skruvmejsel

HORNBAACH Baumarkt AG
Hornbachstraße 11
76879 Bornheim / Deutschland

www.hornbach.com

10446980 - PRŮMYSLOVÉ LED SVÍTIDLO

Demontáž a likvidace

! Výstraha: Následující úkony smí provádět pouze kvalifikovaní elektrikáři.

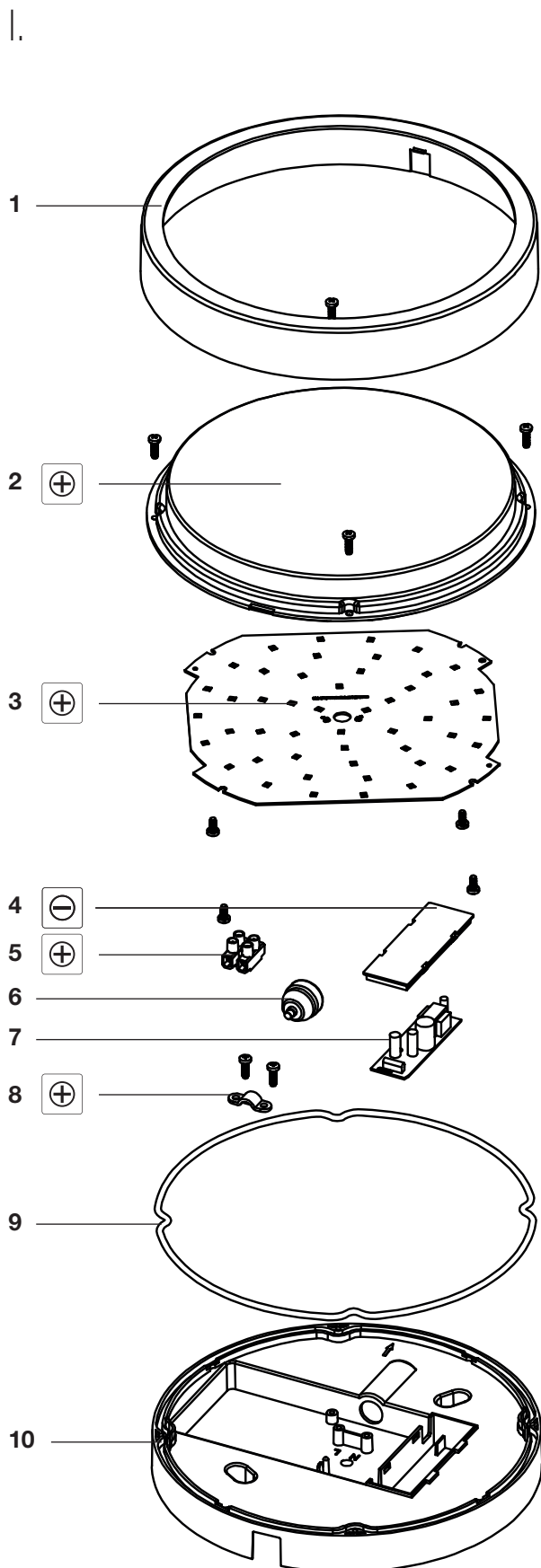

II.

! Upozornění: Před prováděním jakýchkoli úkonů na zařízení jej odpojte od elektrické sítě.

Demontáž

1. Sejměte rám světla **1** ze svítidla.
2. Vyšroubujte stínidlo na lampu **2** ⊕.
3. Uvolněte šrouby na svorkovnici **5** ⊕.
4. Odpojte připojení mezi LED deskou **3** a LED ovladačem **7**.
5. Uvolněte šrouby ochrany proti namáhání **8** ⊕.
6. Odšroubujte LED desku **3** ⊕ od stínidla na lampu.
7. Zdvihněte kryt **4** ⊖ LED ovladače.
8. Odstraňte LED ovladač **7**.

III.

Jednotlivé komponenty likvidujte v souladu s platnými právními předpisy!

Komponenta

- | | |
|----|-----------------------------------|
| 1 | Rám světla |
| 2 | Stínidlo na lampu z mléčného skla |
| 3 | LED deska |
| 4 | Kryt LED ovladače |
| 5 | Svorkovnice |
| 6 | Těsnění |
| 7 | LED ovladač |
| 8 | Ochrana proti namáhání |
| 9 | Těsnicí kroužek |
| 10 | Kryt |

IV.

Potřebné nástroje

- | | |
|---|-------------------|
| ⊕ | Křížový šroubovák |
| ⊖ | Šroubovák |

HORNBACH Baumarkt AG
Hornbachstraße 11
76879 Bornheim / Německo

www.hornbach.com

10446980 - PREPÁŽKOVÉ LED SVIETIDLO

Demontáž a likvidácia



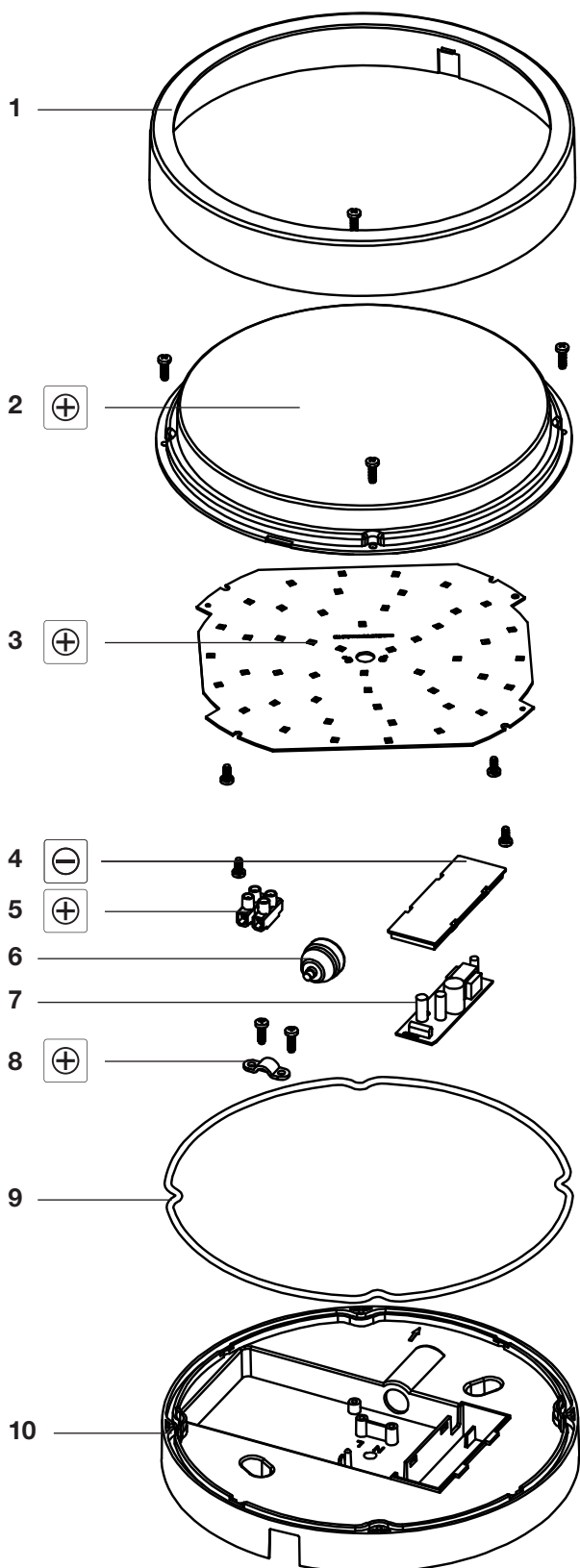

! Výstraha: Nasledujúcu prácu musí vykonať kvalifikovaný elektrikár.



II.

! Upozornenie: Zariadenie pred akýmkoľvek zásahom odpojte od elektrickej siete.

Demontáž

1. Zložte kryt lampy **1** zo svetidla.
2. Odskrutkujte tienidlo lampy **2** .
3. Uvoľníte skrutky svorkovnice **5** .
4. Odpojte spojenie medzi doskou LED **3** a ovládačom LED **7**.
5. Uvoľníte skrutky odľahčenia napätia **8** .
6. Odskrutkujte dosku LED **3**  z tienidla lampy.
7. Nadvihnite kryt **4**  z ovládača LED.
8. Odstráňte ovládač LED **7**.

III.

Jednotlivé komponenty zlikvidujte podľa platných predpisov!

Komponent

- | | |
|----|-------------------|
| 1 | Rám lampy |
| 2 | Mliečne tienidlo |
| 3 | Doska LED |
| 4 | Kryt ovládača LED |
| 5 | Svorkovnica |
| 6 | Tesnenie |
| 7 | Ovládač LED |
| 8 | Uvoľnenie napätia |
| 9 | Tesniaci krúžok |
| 10 | Kryt |

IV.

Požadované nástroje

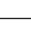
- | | |
|---|-------------------|
|  | Křížový šroubovák |
|  | Šroubovák |

HORNBACH Baumarkt AG
Hornbachstraße 11
76879 Bornheim / Nemecko

www.hornbach.com

10446980 - PLAFONIERĂ CU LED

Demontarea și eliminarea

! Avertisment: Lucrarea următoare trebuie efectuată de un electrician calificat.

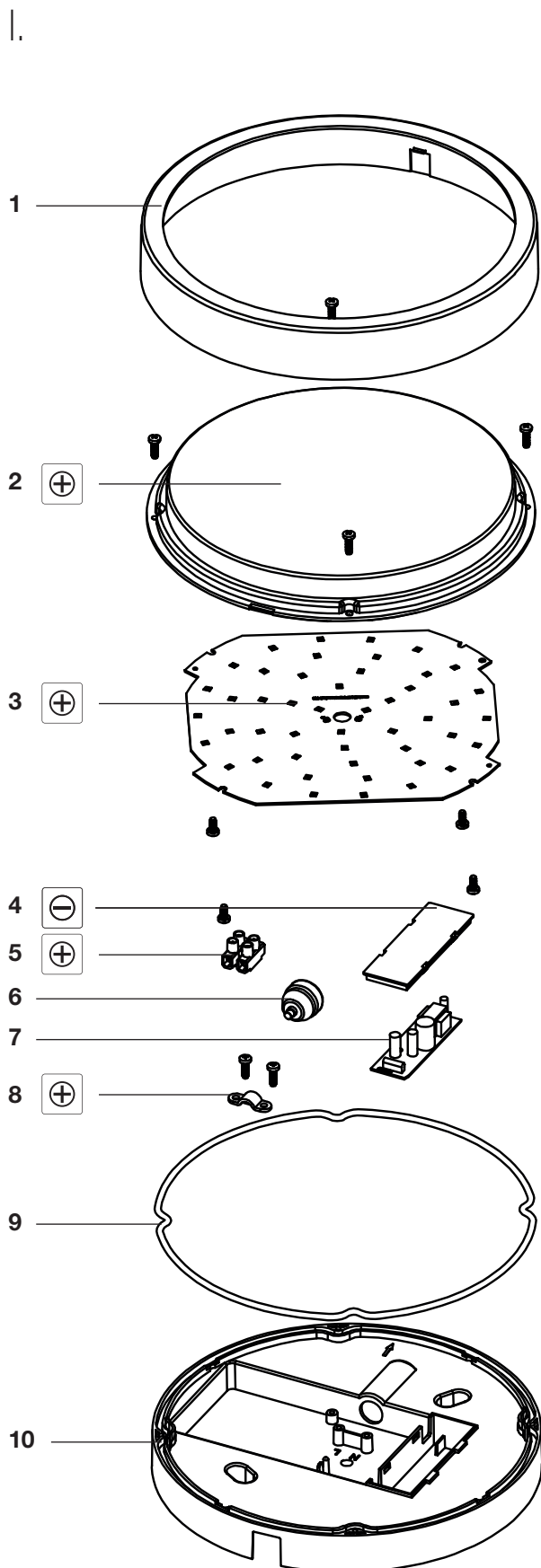

II.

! **Atenție:** Înainte de a efectua orice operațiuni pe dispozitiv, deconectați-l de la rețeaua de alimentare cu energie electrică.

Demontarea

1. Îndepărtați cadrul abajurului **1** de pe corpul de iluminat.
2. Deșurubați abajurul **2** ⊕.
3. Slăbiți șuruburile cutiei de borne **5** ⊕.
4. Deconectați conexiunea dintre placa LED **3** și unitatea LED **7**.
5. Slăbiți șuruburile manșonului de protecție **8** ⊕.
6. Deșurubați placa LED **3** ⊕ de pe abajur.
7. Ridicați capacul **4** ⊖ unității LED.
8. Îndepărtați unitatea LED **7**.

III.

Eliminați componentele individuale în conformitate cu reglementările în vigoare!

Componentă

- | | |
|----|-----------------------|
| 1 | Cadru abajur |
| 2 | Abajur alb ca laptele |
| 3 | Placă LED |
| 4 | Capacul unității LED |
| 5 | Cutie de borne |
| 6 | Garnitură |
| 7 | Unitate LED |
| 8 | Manșon de protecție |
| 9 | Șaibă de etanșare |
| 10 | Carcasă |

IV.

Instrumente necesare

- | | |
|---|----------------------|
| ⊕ | Șurubelniță în cruce |
| ⊖ | Șurubelniță |

HORNBACH Baumarkt AG
Hornbachstraße 11
76879 Bornheim / Deutschland

www.hornbach.com

10446980 - LED-BULKHEAD LUMINAIRE

Dismounting and disposal

Warning: The following work must be performed by a qualified electrician.

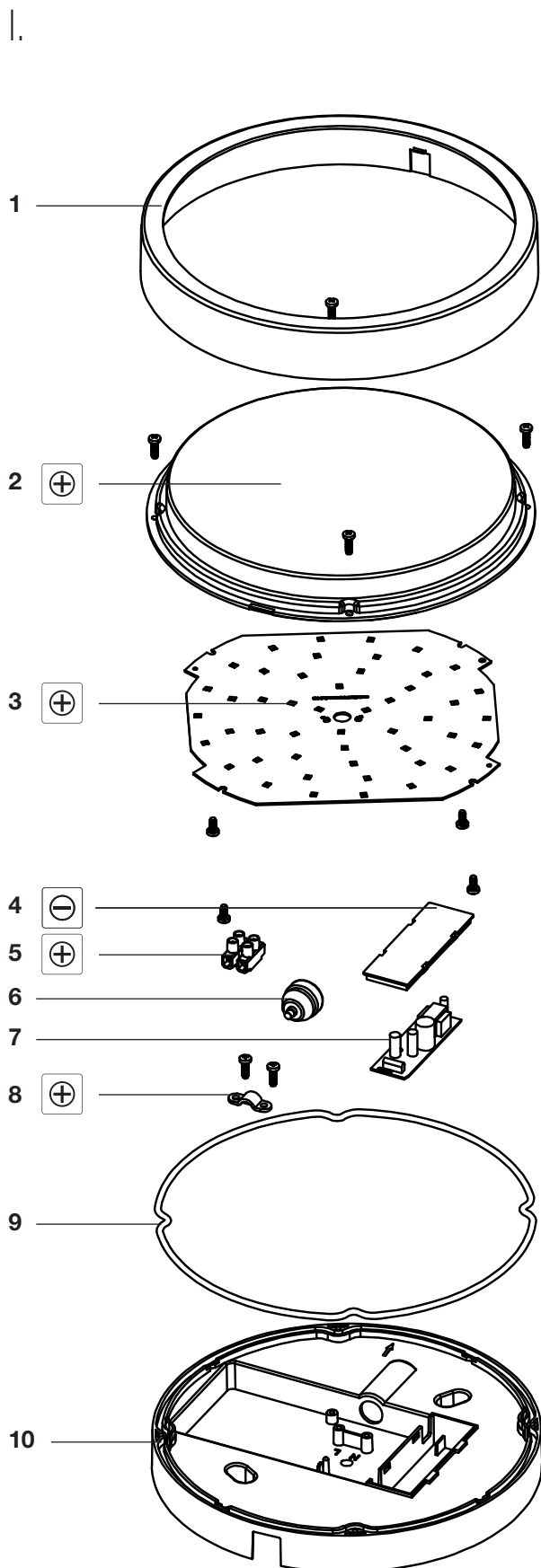

II.

Caution: Disconnect from power mains prior to any operations on the device.

Dismounting

1. Remove the lamp frame **1** from the luminaire.
2. Unscrew the lamp shade **2** ⊕.
3. Loosen the screws of the terminal block **5** ⊕.
4. Unplug the connection between the LED board **3** and the LED driver **7**.
5. Loosen the screws of the strain relief **8** ⊕.
6. Unscrew the LED board **3** ⊕ from the lamp shade.
7. Lift off the cover **4** ⊖ of the LED driver.
8. Remove the LED driver **7**.

III.

Dispose of the individual components according to the applicable regulations!

Component

1	Lamp frame
2	Milky lamp shade
3	LED board
4	Cover of LED driver
5	Terminal block
6	Sealing
7	LED driver
8	Strain relief
9	Sealing ring
10	Housing

IV.

Required tools

⊕	Cross-tip screwdriver
⊖	Screwdriver

HORNBACH Baumarkt AG
Hornbachstraße 11
76879 Bornheim / Deutschland

www.hornbach.com