

HOMESEAL LDS 0.04

www.knaufinsulation.com

WEATHER MEMBRANE

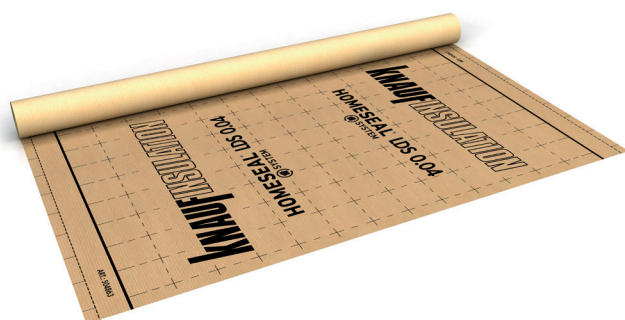

PRODUCT DESCRIPTION

Extremely robust and easy to install weather membrane made of spunbond polypropylene layers with a polypropylene film with an Sd value of 0.02 m compliant with EN 13859. It is highly windproof, breathable and waterproof.

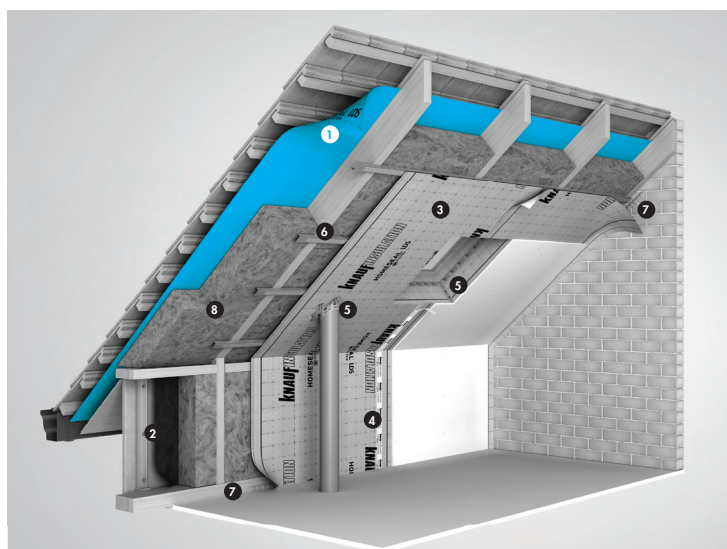

HOMESEAL[®] SYSTEM

Weather membranes

- HOMESEAL LDS 0.02
- 1 HOMESEAL LDS 0.04**
- HOMESEAL LDS 0.04 FIXPLUS
- 2 HOMESEAL LDS 0.02 UV
- HOMESEAL LDS 0.02 UV FIXPLUS

Vapour control layers

- HOMESEAL LDS 2
- HOMESEAL LDS 5
- HOMESEAL LDS 35
- HOMESEAL LDS 40
- 3 HOMESEAL LDS 100**
- HOMESEAL LDS 100 ALUPLUS
- HOMESEAL LDS 200 ALUPLUS
- HOMESEAL LDS FLEXPLUS

Tapes and sealants

- 4 HOMESEAL LDS SOLUPLAN**
- 5 HOMESEAL LDS SOLIFT-1**
- 6 HOMESEAL LDS SOLIFT-2**
- 7 HOMESEAL LDS SOLIMUR 310**

Insulation

- 8 KNAUF INSULATION MINERAL WOOL**

SPECIFICATIONS

Water vapor permeability; Sd value (EN 1931)	0.02 m (-0.01/+0.015)
General Product Standard	EN 13859-1, -2
Certification	Declaration of Performance
Reaction to fire (EN 13501-1)	E
Weight per unit area (EN 1849-2)	Approx. 150 g/m ² (±10 g/m ²)
Waterproofing after artificial ageing (EN 13859-1)	W1
Tensile strength before artificial ageing (EN 12311-2)	310 (L) / 215 (T) N/50mm
Tensile strength after artificial ageing (EN 12310-2)	280 (L) / 190 (T) N/50mm
Tear resistance (EN 12310-2)	165 (L) / 190 (T) N
Flexibility at low temperature (EN 1109)	-20°C
Temperature resistance	-40°C to +80°C
Roll width	1.5 m
Roll length	50 m
m ² /roll	75 m ²

HOMESEAL LDS 0.04

www.knaufinsulation.com

ADDITIONAL INFORMATION

Usage

Breathable waterproofing membrane for the construction of pitched roofs, supported or unsupported, without sarking. It can also be used for vertical wall construction (not UV resistant) as a wind barrier. It can be applied in direct contact with thermal insulation with the recommended overlap.

Applications

Before installing the membrane on the roof, ensure that all surfaces to be covered are securely fastened, clean, dry, and smooth.

The membrane should be installed horizontally on the roof slope (the upper membrane overlaps the lower one), over the insulation or rafters, and secured with flat head nails or non-corrosive staples.

Batten spacing should not exceed 100 cm.

Counter battens are then installed over the underlayment membrane and fastened to the rafters.

Tile battens are attached to the counter battens leaving a space between the underlayment and the battens for rainwater drainage and ventilation.

The membrane must not meet chemical wood treatments, especially when installed in contact with rafters, counter-battens still wet after treatment impregnation.

The membrane should be laid loosely, flat and without folds. Avoid blockages that would prevent the free flow of water.

The number of overlaps should be minimized by using full lengths of sheeting.

Overlaps between membranes should be a minimum of 100 mm depending on the slope of the roof.

Overlaps should be sealed preferably with single- or double-sided adhesive tape.

It is recommended to cover the roof membrane without delay.

Very important: Free water flow and air ventilation are required.

Resistance of the material combinations to ageing

Correctly performed adhesions with certified system components are highly resistant to ageing.

Instructions for use

Please observe the information shown as icons on the packaging. The installation guidelines, standards and recognized rules of technology apply.

Certification and declared properties

The product is CE marked, as it complies with all the criteria of the harmonized standard EN 13984. The declaration of performance (DOP) is available at <https://www.knaufinsulation.com/iframe-cprdop?dopkey=>.

Packaging

The product is delivered in a PE sheet to protect it.

Storage

Rolls should be stored flat on a clean, level surface, and kept away from direct sunlight, rain, and snow. Do not stack pallets or rolls during transport or storage.

APPLICATION GUIDELINES



Place the upper membrane over the edge of the lower one, with an overlap between membranes following regulations.



Place a single-sided adhesive tape to seal membranes overlaps.



Apply a single-sided adhesive tape for closing gaps between ducts, timbers and the membrane.

CE

1390
15

Knauf Insulation Holding GmbH
Am Bahnhof 7
97346 Iphofen
Germany

EN 13859 -1,-2 : 2014

Flexible sheet for underlays for roof
Homeseal LDS 0.04

ABL004CPR
dopki.com/ABL004

All rights reserved, including those of photomechanical reproduction and storage in electronic media. Extreme caution was observed when putting together and processing the information, texts and illustrations in this document. Nevertheless, errors cannot quite be ruled out. The publisher and editors cannot assume legal responsibility or any liability whatever for incorrect information and the consequences thereof. The publisher and editors will be grateful for improvement suggestions and details of possible errors pointed out.

ART.: 504863

challenge.
create.
care.