

## HOMESEAL LDS 2

[www.knaufinsulation.com](http://www.knaufinsulation.com)

### VAPOUR CONTROL LAYER (VCL)

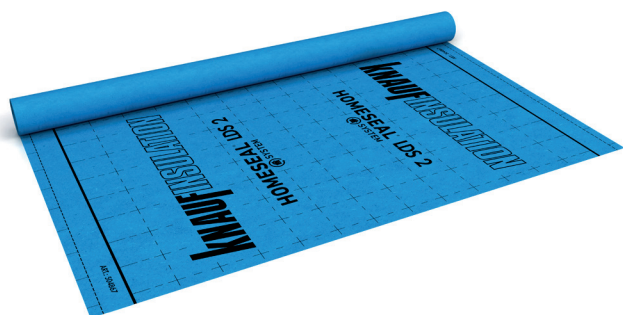

### PRODUCT DESCRIPTION

Vapour control membrane made of two layers, reinforced spunbond polypropylene sheet and a film with an Sd value of 2 m, compliant with EN 13984.

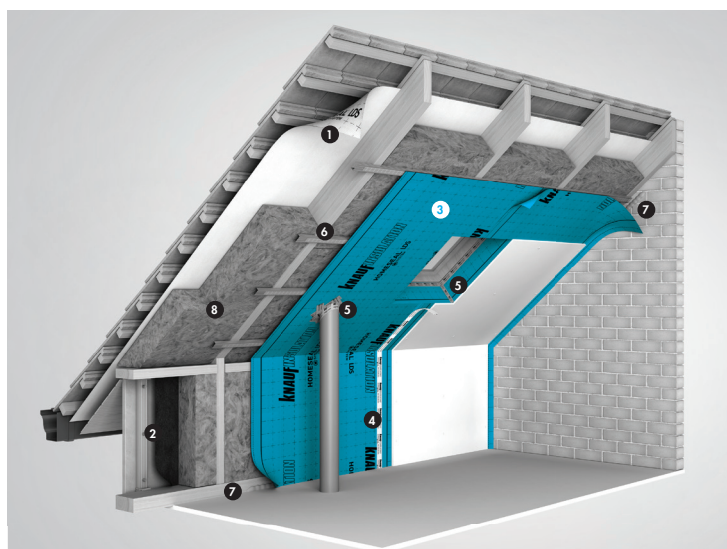

### HOMESEAL<sup>®</sup> SYSTEM

#### Vapour control layers

**HOMESEAL LDS 2**  
HOMESEAL LDS 5  
HOMESEAL LDS 35  
HOMESEAL LDS 40  
**HOMESEAL LDS 100**  
HOMESEAL LDS 100 ALUPLUS  
HOMESEAL LDS 200 ALUPLUS  
HOMESEAL LDS FLEXPUS

#### Weather membranes

HOMESEAL LDS 0.02  
**HOMESEAL LDS 0.04**  
HOMESEAL LDS 0.04 FIXPLUS  
**HOMESEAL LDS 0.02 UV**  
HOMESEAL LDS 0.02 UV FIXPLUS

#### Tapes and sealants

**HOMESEAL LDS SOLUPLAN**  
**HOMESEAL LDS SOLIFT-1**  
**HOMESEAL LDS SOLIFT-2**  
**HOMESEAL LDS SOLIMUR 310**

#### Insulation

**KNAUF INSULATION MINERAL WOOL**

### SPECIFICATIONS

Water vapor permeability; Sd value (EN ISO 1931)	2 m (-0/+1.5 m)
General Product Standard	EN 13984
Certification	Declaration of Performance
Weight per unit area (EN 1849-2)	Approx. 120 g/m <sup>2</sup> (± 10 g/m <sup>2</sup> )
Reaction to fire (EN 13501-1)	E
Water tightness (EN 1928)	Pass
Tensile Strength (EN 12311-2)	180 (L) / 170 (T) N/50mm
Tear resistance (EN 12310-2)	150 (L) / 150 (T) N
Roll width	1.5 m
Roll length	50 m
m <sup>2</sup> /roll	75 m <sup>2</sup>

## HOMESEAL LDS 2

[www.knaufinsulation.com](http://www.knaufinsulation.com)

### ADDITIONAL INFORMATION

#### Usage

For use as a vapour control layer and airtight membrane in timber frame construction. Designed to be used in combination with the components of the Homeseal system. For use as a vapour control layer especially in case of renovation from the outside of a pitched roof. Can also be used as a vapour control layer when working from the inside.

#### Applications

This Vapour Control Layer (VCL) membrane is unrolled onto the insulation, either horizontally or vertically, and fastened with non-corrosive staples or with a double-sided adhesive tape as the "Homeseal LDS Solifit 2" on metal frame. Overlaps should be sealed preferably with a single-sided adhesive tape, as the "Homeseal LDS Soliplan", or the "Homeseal LDS Solifit 1", or with a double-sided adhesive tape as the "Homeseal LDS Solifit 2". Staples should be covered with a single-sided adhesive tape.

Penetrations or connections to adjoining building components should be properly sealed, ideally with the tapes "Homeseal LDS Soliplan", "Homeseal LDS Solifit 1", or "Homeseal LDS Solifit 2".

The VCL membrane should be laid loose, flat, and wrinkle-free. Wherever possible, the number of overlaps should be kept to a minimum by using full lengths of sheeting.

Attention to details is important. Perfect sealing of overlaps or penetrations is necessary to maintain an air tightness of the interior envelope.

#### Resistance of the material combinations to ageing

Correctly performed adhesions with certified system components are highly resistant to ageing.

#### Instructions for use

Please observe the information shown as icons on the packaging. The installation guidelines, standards and recognized rules of technology apply.

#### Certification and declared properties

The product is CE marked, as it complies with all the criteria of the harmonized standard EN 13984. The declaration of performance (DOP) is available at <https://www.knaufinsulation.com/iframe-cprdop?dopkey=>.

#### Packaging

The product is delivered in a PE sheet to protect it.

#### Storage

Rolls should be stored flat on a clean, level surface, and kept away from direct sunlight, rain, and snow. Do not stack pallets or rolls during transport or storage.

### APPLICATION GUIDELINES



The building must be ventilated to ensure relative humidity stays below 75% during fitting.



Apply staples at a distance of 10-15 cm



Place Homeseal LDS Solifit-2, 2-sided adhesive tape, before applying the membrane



Place the Homeseal LDS Soliplan, 1-sided adhesive tape, to seal the overlap



Always apply the membrane across the bearing elements



Use some pressure to ensure the proper adhesion of the tape on the membrane



Place the membrane with a 10 cm overlap



Create airtight connections between Homeseal membranes and construction elements with Homeseal LDS Solimur glue



Use staples size 8/10



Apply Homeseal LDS Solifit-1 tape for closing the gap between ducts and membranes



1390  
15

Knauf Insulation Holding GmbH  
Am Bahnhof 7  
97346 Iphofen  
Germany

EN 13984:2013

Flexible sheet for vapour control  
Homeseal LDS 2

ABLD52CPR  
[dopki.com/ABLD52](http://dopki.com/ABLD52)

All rights reserved, including those of photomechanical reproduction and storage in electronic media. Extreme caution was observed when putting together and processing the information, texts and illustrations in this document. Nevertheless, errors cannot quite be ruled out. The publisher and editors cannot assume legal responsibility or any liability whatever for incorrect information and the consequences thereof. The publisher and editors will be grateful for improvement suggestions and details of possible errors pointed out.

ART.: 504867

challenge.  
create.  
care.