

(WINDOW SASH LOCK)

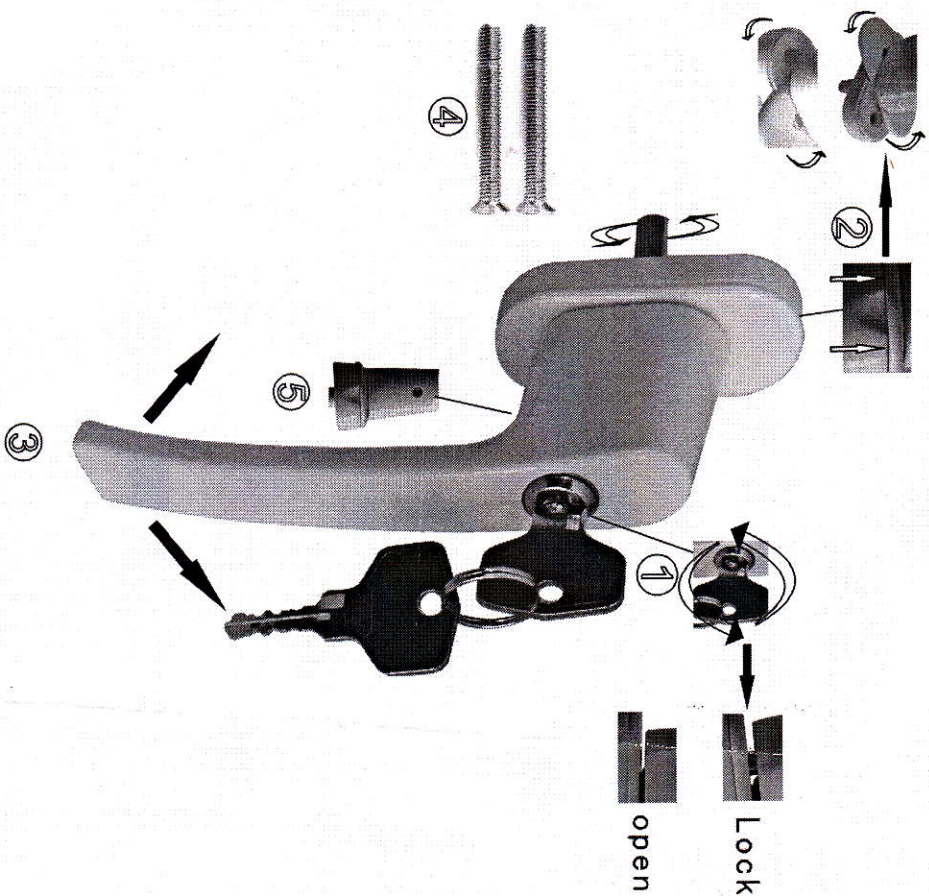

NO.	ITEM NAME	QUANTITY	MARK
1	Lock Core	1	
2	Ornament Cover	1	
3	Window-handle	1	
4	Machine Screw	2	
5	Socket Head Cap Screw	1	

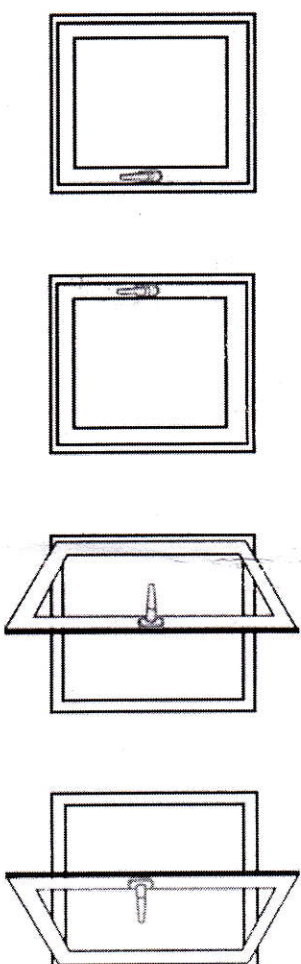

As shown by the handle, the locking state to one side of the glass rotating 90 degrees to flat open state, the inward pull the handle to open windows can be opened flat. When closed, the opening sash need to on close completely at the first, and then handle reverse rotation 90 ° , locking the opening sash.

A, use matters: 1, change the way of opening or rotating the handle, it must first be opening sash completely shut down, then the handle is rotated to the corresponding position, implemented open state transition. 2, in the process of rotating handle, must keep open the sash in a fully closed state. 3, in stall the anti-disoperation device window, in the open door is not fully closed, mandatory rotation handle will destroy the anti-disoperation device. 4, in either open or closed state, please keep the handle in a horizontal or vertical position.

B, the maintenance suggestions: these doors and windows with high quality hardware accessories. This means: simple operation, strong function, strong persistence. Realization of function, smooth operation of hardware accessories condition is in accord with our window size and weight requirements. Hardware accessories and function can be checked in accordance with the following criteria: 1 the smooth operation of the 2 pieces of metal fixed 3 pieces of metal wear 4 pieces of metal damage. We are through the inspection window handle to check the hardware system is capable of smooth operation. According to the German industrial standard, locking and opening the window, handle allows the maximum torque applied to 10 nm. In the inspection process, we use a torque wrench to detect the torque. Timely to the hardware system of gas or adjust the coordination between hardware can make the operation more smoothly. Incorrect or improper adjustment may lead to hardware components cannot be normal use.